

# OnSite Standard Product



## Key Specifications

**Diameter:** 45mm / 1.75in  
**Length:** 163mm / 6.4in  
**Weight:** 0.5kg / 1.1lb  
**Material:** Aluminum (optional 316 stainless steel)  
**Depth Rating:** 30m / 100ft (optional 150m / 500ft)  
**Maximum Tether Length:** 500m / 1,650ft  
**Operating Temperature:** 0° - 40° C / 32° - 104° F

**Minimum Illumination:** 1.0 lux  
**Resolution:** 420 TV lines  
**Focus:** Manual (remote)  
**Iris:** Auto  
**Lights:** 6 x High intensity LEDs  
**Controls:** 360° continuous pan, 280° tilt, focus, light  
**Variable Pan Speed:** 0-26°/sec  
**Variable Tilt Speed:** 0-12°/sec  
**HFOV:** 53° in air  
**Format:** PAL or NTSC  
**Power:** Voltage (Nom) = 40-54VDC 10W  
**Lens:** 3.6mm  
**Focal Range:** 5mm to infinity

# Spectrum 45™ (SP45)



## Industries & Applications

- Mining
- Municipal (Sewer/Water)
- Nuclear
- Oil & Gas (Onshore/Offshore)
- Petrochemical

Inuktun's robust Spectrum 45™ camera offers precision pan and tilt capability in an extremely compact waterproof package. Easy to deploy and operate, the system incorporates controls for remote focus and built-in LED lighting allowing maximum visibility in low light conditions and confined spaces. And, with long cable deployment options and the ability to function effectively in air or underwater, it can be used almost anywhere.

One of the smallest cameras in its class, the Spectrum 45™ is available as a stand-alone system for visual examination inside of caissons, wells, and pressure vessels. When integrated with the Inuktun Versatrax 100™, MicroMag™ or NanoMag™ crawlers, it is ideal for inspecting a wide range of infrastructure including piping, storage tanks and nuclear reactors. And, because the Spectrum 45™ adheres to our Multi-Mission Modular (IM3™) design philosophy, it can be easily integrated into third party designs including Remotely Operated Vehicles (ROVs), manipulators or pipe inspection systems.



*"The SP45 addresses the market's shortfall in size, with combined pan and tilt functionality. For entry size, image quality and even subsea applications, this 45mm diameter is the solution... Ticks the box in every respect."*

– J. De Silveria, Director, Nexxis

All specifications are subject to change

# Spectrum 45™

## STANDARD IM3 OPTIONS

Custom configurations:  
See dealer for details



**Material**  
Aluminum  
or  
Stainless Steel

**Depth Rating**  
30m / 100ft  
or  
150m / 500ft  
*Sacrificial anodes for subsea applications available*  
*Miniature size for confined spaces.*  
*High intensity built-in LEDs for maximum penetration, visibility & image quality*



**Control System**  
Spectrum™ or Versatrax™ controller; Pelican® case; membrane panel with joystick input, video text overlay with keyboard entry, date/time & camera feedback.



**Carbon Fibre Pole**  
Telescopic deployment pole for ad-hoc or scheduled inspections in confined, restricted or out-of-reach spaces: length to 5m / 16ft.



**Tether Management**  
Hard shell roller case with custom foam for miniature cable reel.

### Connector Pin-out

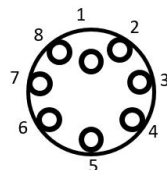

FACE VIEW

CN1	
GND	1
VIN	2
RS485A	3
RS485B	4
SpareA	5
SpareB	6
Video(+)	7
Video(-)	8

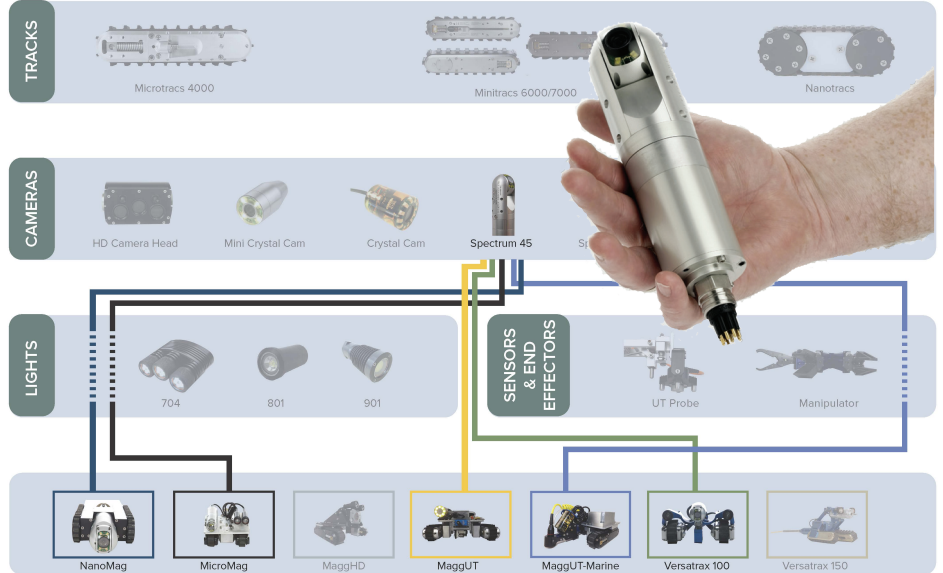

## Spectrum 45™ Dimensions

Call for imperial/metric fastener measurements

### 30m/100ft version

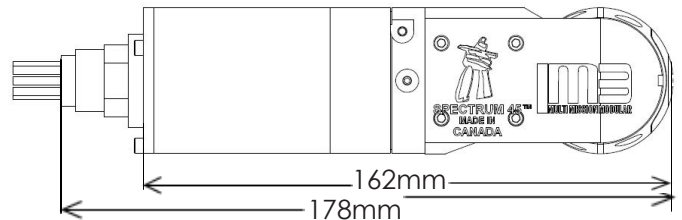

Ø 45mm

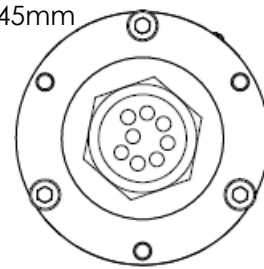

### 150m/500ft version

